

Level Set Attenuators

Summary:

The Level Set Attenuator is used to adjust power, reduce reflection interaction, and provide isolation where needed. Adjustment is accomplished by loosening the clamping screws and raising or lowering the Mylar vane by hand until the desired attenuation value is achieved and then re-tightening the screws. These attenuators provide reliable performance when continuously variable settings are not required. Level Set Attenuators are available in sizes WR3 to WR42. Sizes WR2.8 and WR2.2 are also available upon request.



Ordering Example:

LA22R is a Level Set Attenuator in WR22 with Round flange hole patterns.

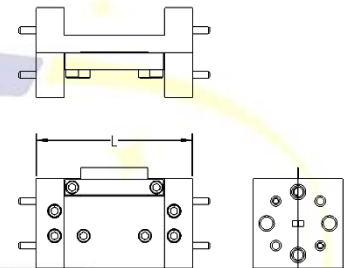

Part Name	RF Specifications			Mechanical Specifications			
	WR	Frequency (GHz)	VSWR	WG A DIM (in)	WG B DIM (in)	Length - A (in)	Flange
LA42S	42	18 - 26.5	1.15:1	0.4200	0.1700	*	S 0.875
LA28S	28	26.5 - 40	1.15:1	0.2800	0.1400	*	S 0.750
LA22R	22	33 - 50	1.15:1	0.2240	0.1120	2.000	R 1.125
LA19R	19	40 - 60	1.15:1	0.1880	0.0940	1.800	R 1.125
LA15R	15	50 - 75	1.15:1	0.1480	0.0740	1.600	R 0.750
LA12R	12	60 - 90	1.2:1	0.1220	0.0610	1.500	R 0.750
LA10R	10	75 - 110	1.2:1	0.1000	0.0500	1.400	R 0.750
LA8R	8	90 - 140	1.2:1	0.0800	0.0400	1.300	R 0.750
LA6R	6	110 - 175	1.2:1	0.0650	0.0325	1.300	R 0.750
LA5R	5	140 - 220	1.2:1	0.0510	0.0255	1.300	R 0.750
LA4R	4	170 - 260	1.2:1	0.0430	0.0215	1.200	R 0.750
LA3R	3	220 - 325	1.2:1	0.0340	0.0170	1.200	R 0.750

Custom Microwave Inc

custommicrowave.com

24 Boston Ct – Longmont, Colorado

303-651-0707